

# State of Wyoming Corner Record

(In compliance with the CORNER PERPETUATION AND FILING ACT, Wyoming Statutes, 1997 Section 33-29-140 et. seq., and the Rules and Regulations of the Board of Professional Engineers and Professional Land Surveyors)

Reverse side of this form may be used if more space is needed.

Record of original survey and citation of source of historical information (if corner is lost or obliterated). Description of corner monumentation evidence found and/or monument and accessories established to perpetuate the location of this corner. Sketch of relative location of monument, accessories, and reference points with course and distance to adjacent corner(s) (if determined in this survey). Method and rationale for reestablishment of lost or obliterated corner.

**RECORD:** UNKNOWN

**MONUMENT FOUND:** FOUND A 2" BRASS CAP "DMH" PROJECTING 2' ABOVE GROUND ON A 2" IRON PIPE.

**MONUMENT SET:** SET A 3/4" X 30" REBAR WITH A 3/4" ALUMINUM CAP, FLUSH WITH THE GROUND. WITNESS CORNER 65.00' NORTH ON LINE FROM THE W 1/4 OF SECTION 16 TO THE NW SECTION CORNER OF SECTION 16, DUE TO CONSTRUCTION OF BUILDING OVER THE 1/4 CORNER. CAP STAMPED AS SHOWN BELOW.

**REFERENCES:** REFERENCES ARE SHOWN BELOW.



RECP #: 651830

RECORDED 12/23/2014 AT 4:13 PM BK# 2422 PG# 306  
Debra K. Lathrop, CLERK OF LARAMIE COUNTY, WY PAGE 1 OF 1

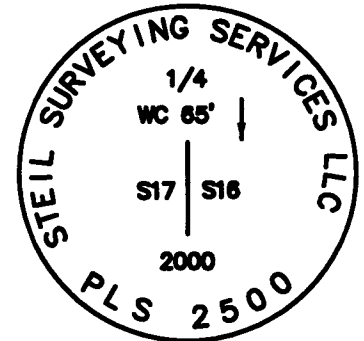
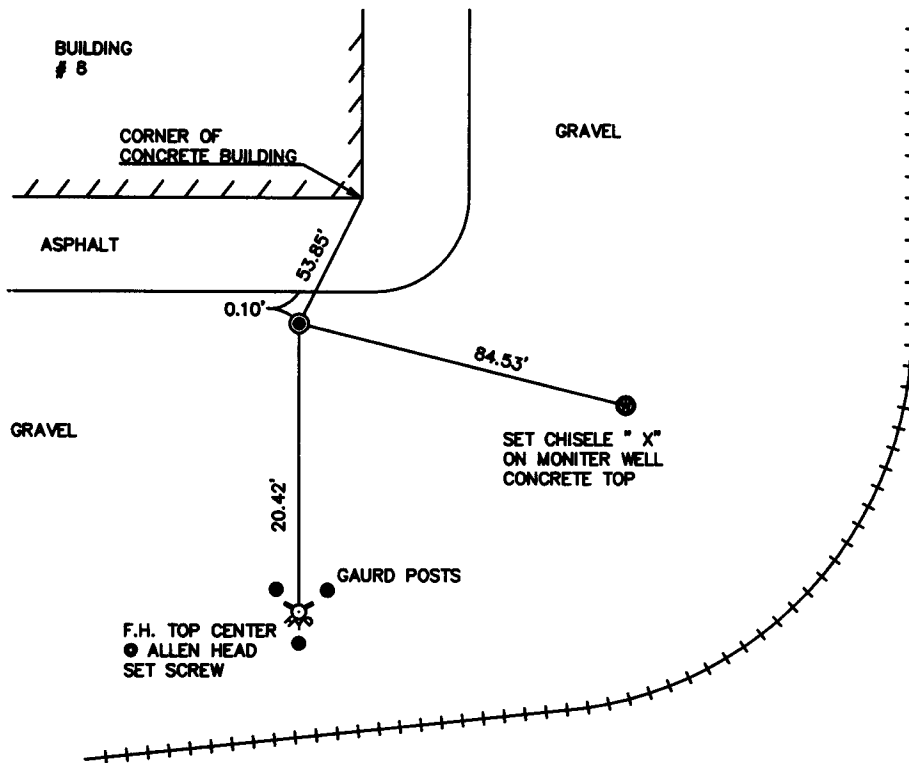

Date of Field Work: 6/21/00

Office Reference: 20307

## Monument Inscription

### Cross Index Plat

	1	2	3	4	5	6	7	8	9	10	11	12	13	14	15	16	17	18	19	20	21	22	23	24	25
A																									
B																									
C		6			5				4					3					2						1
D																									
E																									
F																									
G																									
H																									
J																									
K																									
L																									
M																									
N																									
O																									
P																									
Q																									
R																									
S																									
T																									
U																									
V																									
W																									
X																									
Y																									
Z																									

Firm/Agency, Address

**STEIL SURVEYING SERVICES LLC**  
**1102 WEST 19th STREET**  
**CHEYENNE WY 82001**  
Telephone Number: **(307) 634-7273**

This corner record was prepared by me or under my direction and supervision.

SEAL & SIGNATURE

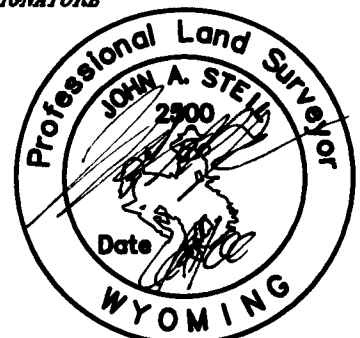

Corner Name WEST 1/4 Corner Section 16, T 13 N, R 67 W, 6th P.M.  
County: LARAMIE Wyoming

Cross-Index No.: L-9